

# Data Sheet

## PW063xxVBBN

Page 1/5

P/N

315241xx

xx=number of poles

2014/01/28

### Illustration

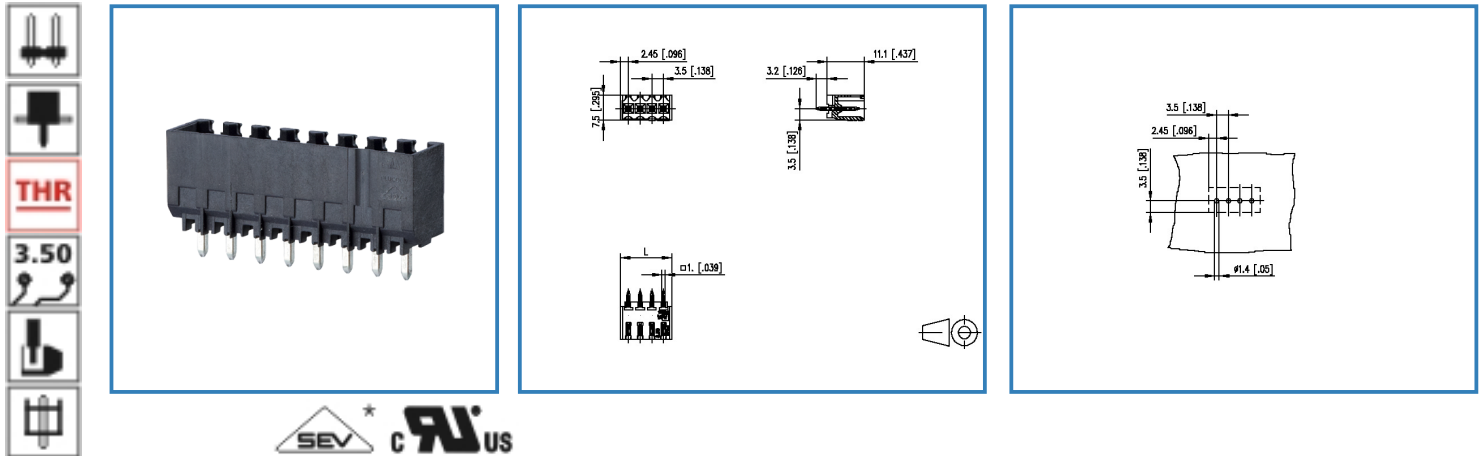

see enlarged drawing at the end of the document

### Product specification

- pin header, THR solderable
- centerline 3.50 mm, direction of connection vertical 0°
- closed ends
- color black
- Tape & Reel packaging
- with alternative face, codeable
- Connection data

**CULUS** V / A 300 / 10

**SEV** 10 A / 130 V / 2.5 kV / 3 / IEC 61984



# Data Sheet



## PW063xxVBBN

### Technical Data

#### General Data

|                           |         |        |        |
|---------------------------|---------|--------|--------|
| Solder pin length         | 3.2 mm  |        |        |
| min. number of poles      | 2       |        |        |
| max. number of poles      | 24      |        |        |
| Insulating material class | CTI 400 |        |        |
| clearance/creepage dist.  | 2.48 mm |        |        |
| protection category       | IP 10   |        |        |
| Overvoltage category      | III     | III    | II     |
| Pollution degree          | 3       | 2      | 2      |
| Rated voltage             | 160 V   | 320 V  | 320 V  |
| Rated test voltage        | 2.5 kV  | 2.5 kV | 2.5 kV |

#### Connection data

|  |                                       |
|--|---------------------------------------|
|  V / A | 300 / 10                              |
|        | 10 A / 130 V / 2.5 kV / 3 / IEC 61984 |

#### Material

|                      |         |
|----------------------|---------|
| insulating material  | PA46    |
| flammability class   | V0      |
| contact pin material | CuMg    |
| contact pin surface  | Cu + Sn |

#### Climatic properties

|                         |        |
|-------------------------|--------|
| upper limit temperature | 105 °C |
| lower limit temperature | -40 °C |

#### General

|               |                                    |
|---------------|------------------------------------|
| solderability | Acc. to IPC/JEDEC J-STD-020D-MSL 1 |
| Tolerance     | ISO 2768 -mH                       |



# Data Sheet

## PW063xxVBNN

Page 3/5

P/N

315241xx

xx=number of poles

2014/01/28

### Matching Part to

| P/N         | Product name        |
|-------------|---------------------|
| 315131      | RW043xxHBLD Typ 513 |
| 315141      | RW043xxHBLC Typ 514 |
| FW143XXVBFC | FW143xxVBFC         |
| SW063XXVBNN | SW063xxVBNN         |

### Accessories

| P/N                      | Product name |
|--------------------------|--------------|
| 700268-01-0 (on request) | F_Kodier sw  |
| 700268-0132 (on request) | F_Kodier sw  |
| 700268-0194 (on request) | F_Kodier sw  |



# Data Sheet

## PW063xxVBBN

Page 4/5

P/N

315241xx

xx=number of poles

2014/01/28

### Illustration

Drawing

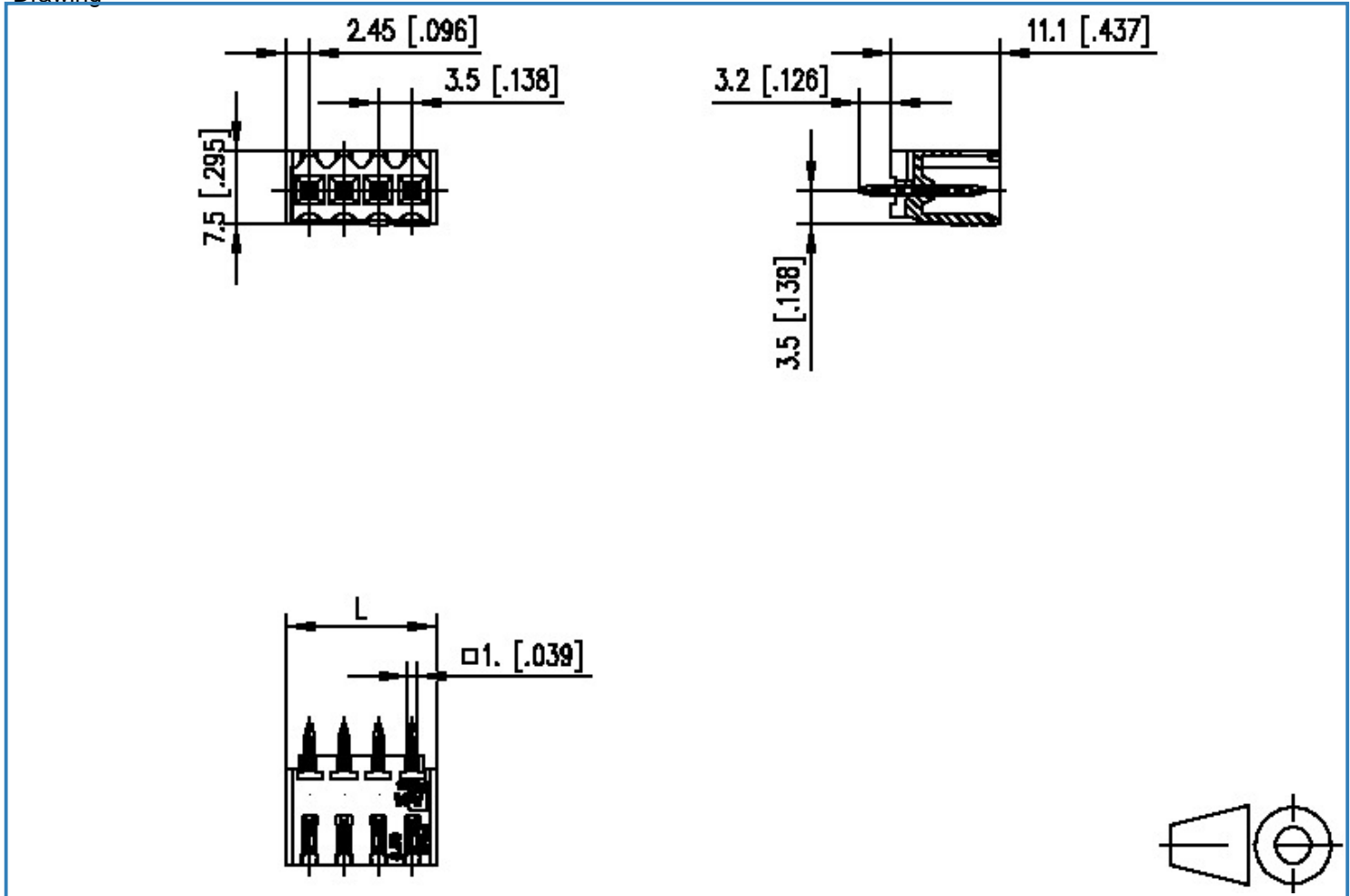

$L = (\text{pole size} - 1) \times \text{centerline} + 4.9 [0.193]$



# Data Sheet

## PW063xxVBBN

Page 5/5

P/N

315241xx

xx=number of poles

2014/01/28

### PCB Layout

