

Terminal blocks

to Type 374

ASP051 page 47

Type 374

Header, centerline 2.5 mm / 0.098 inches, horizontal mounting, square pins 0.8 mm / 0.031 inches, closed ends

Technical Data

V / A	150 / 5
	130 V / 2.5 kV / 4 A
Insulation co-ordination according to IEC 664-1	
Clearance and creepage distances	min. 1.7 mm
Insulating material class	CTI 600
Overvoltage category	III III II
Pollution degree	3 2 2
Rated voltage	80 320 320
Rated test voltage	0.8 4 2.5
Protection category according to IEC 529	IP00
Solder pin dimension	0.8 x 0.8 mm
Recommended pc board hole dia.	Ø 1.3 mm
Solder pin length	3.2 mm
Pole size	2 - 12
Color	green

Dimensions in mm 1 mm = 0.0394 in.

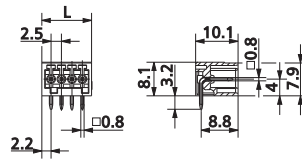

$L = (\text{pole size} - 1) \times \text{centerline} + 4.4 \text{ mm} / 0.173 \text{ inches}$

Part numbers (P/N)

(informations: page 111)

Complete the part number by adding the pole size.

Type 374

centerline 2.5 mm / 0.098 inches

P/N 313741

<input type="text"/>	02	03	04	05	06	07	08
	09	10	11	12			

- Standard pole sizes
- Available on demand. Minimum order quantity 5000 pieces per item.