

Data Sheet

PR044xxVBBN

Page 1/5

P/N

311911xx

xx=number of poles

2014/01/27

Illustration

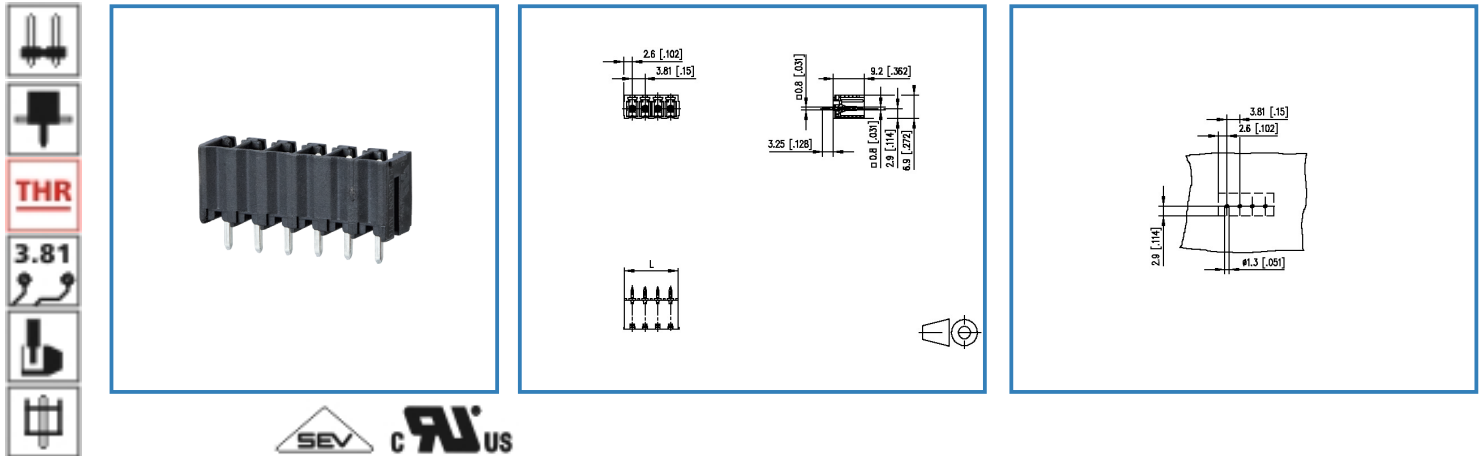

see enlarged drawing at the end of the document

Product specification

- pin header, THR solderable
- centerline 3.81 mm, direction of connection vertical 0°
- closed ends
- color black
- Tape & Reel packaging
- codeable
- Connection data

cRUUS V / A 300 / 8

SEV 10 A / 130 V / 2.5 kV / 3 / IEC 61984

Data Sheet



PR044xxVBBN

Technical Data

General Data

| | | | |
|---------------------------|---------|-------|--------|
| Solder pin length | 3.25 mm | | |
| min. number of poles | 2 | | |
| max. number of poles | 12 | | |
| Insulating material class | CTI 600 | | |
| clearance/creepage dist. | 3.01 mm | | |
| protection category | IP 00 | | |
| Overvoltage category | III | III | II |
| Pollution degree | 3 | 2 | 2 |
| Rated voltage | 200 V | 500 V | 500 V |
| Rated test voltage | 4.0 kV | 4 kV | 4.0 kV |

Connection data

| | |
|--|---------------------------------------|
|  V / A | 300 / 8 |
|  | 10 A / 130 V / 2.5 kV / 3 / IEC 61984 |

Material

| | |
|----------------------|---------|
| insulating material | PA66/6T |
| flammability class | V0 |
| contact pin material | CuMg |
| contact pin surface | Ni + Sn |

Climatic properties

| | |
|-------------------------|--------|
| upper limit temperature | 105 °C |
| lower limit temperature | -40 °C |

General

| | |
|---------------|------------------------------------|
| solderability | Acc. to IPC/JEDEC J-STD-020D-MSL 1 |
| Tolerance | ISO 2768 -mH |

Data Sheet

PR044xxVBBN

Page 3/5

P/N

311911xx

xx=number of poles

2014/01/27

Matching Part to

| P/N | Product name |
|--------|---------------------|
| 311131 | RP034xxHBLO Typ 113 |
| 311141 | RP034xxHBLN Typ 114 |
| 313691 | RP034xxVBLN Typ 369 |
| ASP044 | SP044xxVBNN ASP044 |
| ASP064 | SP064xxVGNN ASP064 |

Accessories

| P/N | Product name |
|-------------|--------------|
| 720293-01-2 | 720293 |



Data Sheet

PR044xxVBBN

Page 4/5

P/N

311911xx

xx=number of poles

2014/01/27

Illustration

Drawing

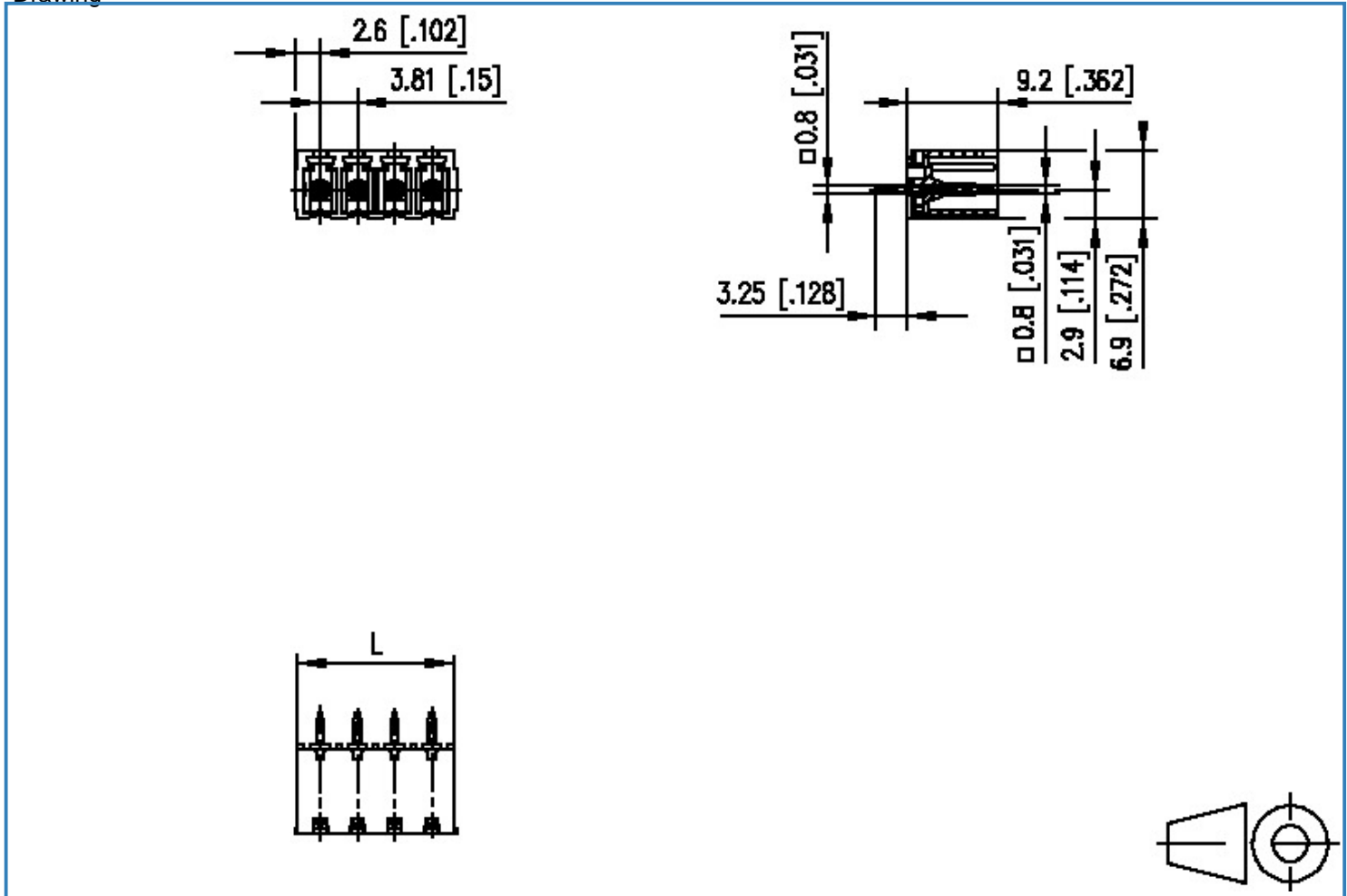

$L = (\text{pole size} - 1) \times \text{centerline} + 5.2 [0.205]$



Data Sheet

PR044xxVBBN

Page 5/5

P/N

311911xx

xx=number of poles

2014/01/27

PCB Layout

